



GARRISON

RESILIENT

Vinyl and Laminate flooring designed with authentic hardwood visuals and constructed for incredible durability.



SPC

**ELEMENTS
METROPOLITAN
NATURESTEP
SUMMIT SKY**

WPC

**AQUABLUE
AQUABLUE II**

WSPC

ZODIAC

LAMINATE

AZUL WATERS

GLUE DOWN LVT

COUNTRY CHARM



ALLOY

ELEMENTS SPC

Inspired by the elements of the earth, this collection pairs the strength of stone with the aesthetic of wood. Constructed with an ultra-durable, water-resistant SPC (Stone Polymer Composite) core with an attached EVA foam underlayment, precisely micro-beveled edges, and available in seven and nine inch widths, every color in this collection is a smart and stylish choice. From the warm, rich tones of Copper and Gold, to the cool, modern looks of Alloy and Steel - and everything in between - any option in the Elements collection will become the key element of your interior space.

WIDTH	7 inches, 9 inches (see below)	SURFACE TEXTURE	Varies (see below)
THICKNESS	6.5 mm	FINISH	UV Coating and Tempering
LENGTH	5 feet	WEIGHT PER BOX	7 inches: 50 lbs 9 inches: 48 lbs
WEAR LAYER	0.5 mm (20 mil)	COVERAGE PER BOX	7 inches: 24.14 sq ft 9 inches: 22.88 sq ft
CONSTRUCTION	SPC Vinyl with EVA Underlayment	EDGE DETAIL	Painted Micro-Bevel

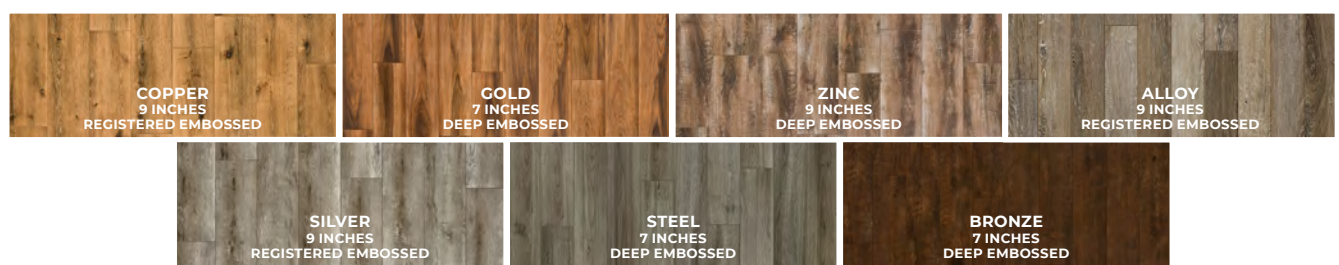

INSTALLATION



EASY CLICK

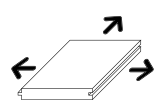

FLOATING

MOULDINGS AVAILABLE

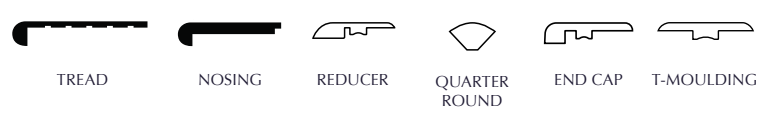

RESILIENT

Versatile. Sensible. Effortless.

The Resilient line of Garrison floors represents a wide range of easy-to-install, high quality vinyl and laminate options. Get the look and feel of real hardwood flooring with the proven durability of Garrison water-resistant technology.



SCAN WITH PHONE CAMERA FOR IMAGES AND MORE INFORMATION

www.garrisoncollection.com
(800) 300-5158 | info@garrisoncollection.com

Sample Variation Disclaimer: Due to the natural variations in color, grain, and texture inherent in the hardwood products used to design this flooring, flooring will vary from plank to plank and may vary slightly from these samples. Please expect variation in all flooring. Samples that have been exposed to sunlight or naturally aged may differ slightly from the product received. Garrison accepts no liability for claims due to variations in color, grain, and/or character between these samples and your installed floor. INSTALLATION IS ACCEPTANCE.

Product Disclaimer: All measurements are nominal. Wear layer refers to top layer thickness prior to treatment. Embossing may marginally affect wear layer thickness. All boxes include starter boards.

Order Disclaimer: We recommend buying all flooring at the same time for your project. When ordering, always factor in at least one full box for any/all unforeseen damage that may occur during the life of your floor. Please consider and allow for a waste factor of 3-5% on normal layouts and 5-10% on detailed layouts such as 45-degree angles, patterns, border work, etc. Please also include end joint stagger and note that minor imperfections are to be cut off prior to installation.

Installation Disclaimer: This flooring must be installed in accordance to our installation instructions, included in all cartons of our flooring. Proper subfloor testing must be performed and Garrison Vinyl Moisture Barrier and 3M Seam Tape (or equivalent products) must be used at installation. More detailed installation instructions can be found on our website at garrisoncollection.com. Improper installation will void your warranty.

Warranty Disclaimer: This flooring comes fully finished from the factory and requires no immediate surface treatment following installation. Improper installation or the use of improper products and/or cleaning methods will void your warranty. Please refer to full Care & Maintenance Guide available for this flooring at garrisoncollection.com.



NOLITA

METROPOLITAN SPC

Inspired by the bustling cityscape of New York, this collection was built with high-traffic durability and stunning aesthetics in mind. Constructed with an ultra-durable water-resistant SPC (Stone Polymer Composite) core with an attached EVA foam underlayment, precisely micro-beveled edges, and available in seven and nine inch widths, every color in this collection is as iconic as the neighborhoods of NYC. From the warm tones in Gramercy Park to the contemporary clean looks of Hudson – and everything in between – any option in this collection will embody the energy of your interior space.

WIDTH	7 inches, 9 inches (see below)	SURFACE TEXTURE	Varies (see below)
THICKNESS	6.5 mm	FINISH	UV Coating and Tempering
LENGTH	5 feet	WEIGHT PER BOX	7 inches: 52 lbs 9 inches: 49 lbs
WEAR LAYER	0.5 mm (20 mil)	COVERAGE PER BOX	7 inches: 24.14 sq ft 9 inches: 22.88 sq ft
CONSTRUCTION	SPC Vinyl with EVA Underlayment	EDGE DETAIL	Painted V-Groove

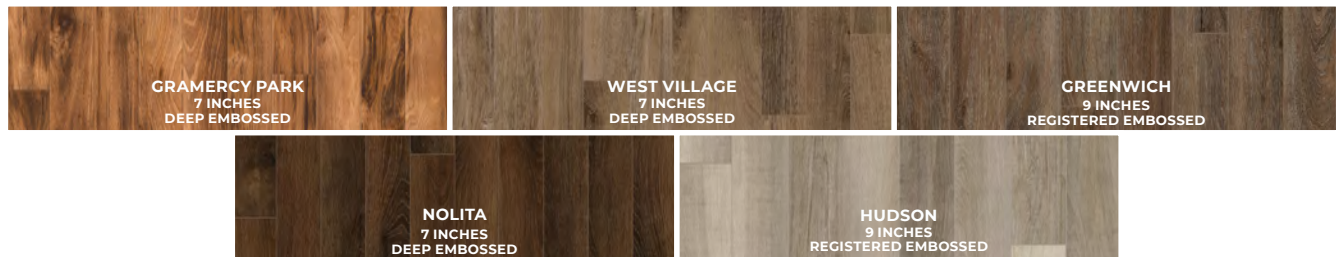

INSTALLATION

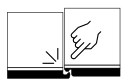

EASY CLICK

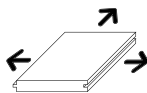

FLOATING

MOULDINGS AVAILABLE



TREAD



NOSING



REDUCER



QUARTER ROUND



END CAP

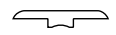

T-MOULDING



RESILIENT

Versatile. Sensible. Effortless.

The Resilient line of Garrison floors represents a wide range of easy-to-install, high quality vinyl and laminate options. Get the look and feel of real hardwood flooring with the proven durability of Garrison water-resistant technology.



SCAN WITH
PHONE CAMERA FOR
IMAGES AND MORE
INFORMATION

www.garrisoncollection.com

(800) 300-5158 | info@garrisoncollection.com

Sample Variation Disclaimer: Due to the natural variations in color, grain, and texture inherent in the hardwood products used to design this flooring, flooring will vary from plank to plank and may vary slightly from these samples. Please expect variation in all flooring. Samples that have been exposed to sunlight or naturally aged may differ slightly from the product received. Garrison accepts no liability for claims due to variations in color, grain, and/or character between these samples and your installed floor. INSTALLATION IS ACCEPTANCE.

Product Disclaimer: All measurements are nominal. Wear layer refers to top layer thickness prior to treatment. Embossing may marginally affect wear layer thickness. All boxes include starter boards.

Order Disclaimer: We recommend buying all flooring at the same time for your project. When ordering, always factor in at least one full box for any/all unforeseen damage that may occur during the life of your floor. Please consider and allow for a waste factor of 3-5% on normal layouts and 5-10% on detailed layouts such as 45-degree angles, patterns, border work, etc. Please also include end joint stagger and note that minor imperfections are to be cut off prior to installation.

Installation Disclaimer: This flooring must be installed in accordance to our installation instructions, included in all cartons of our flooring. Proper subfloor testing must be performed and Garrison Vinyl Moisture Barrier and 3M Seam Tape (or equivalent products) must be used at installation. More detailed installation instructions can be found on our website at garrisoncollection.com. Improper installation will void your warranty.

Warranty Disclaimer: This flooring comes fully finished from the factory and requires no immediate surface treatment following installation. Improper installation or the use of improper products and/or cleaning methods will void your warranty. Please refer to full Care & Maintenance Guide available for this flooring at garrisoncollection.com.



SANDALWOOD

NATURESTEP SPC

NatureStep is the culmination of innovation in construction and design, an ode to the organic beauty of nature and the achievement of modern technology in resilient SPC water-resistant flooring. This collection features Embossed-in-Register (EIR) technology in a clean, natural color palette that is entirely exclusive to Garrison. As a result, the individual graining of the floor's visual is precisely matched to the surface texture, capturing the look and feel of real wood with the durability of a worry-free Garrison Resilient floor. Step into the most realistic, premium, and impressive SPC collection with NatureStep.

WIDTH	8.66 inches	SURFACE TEXTURE	Embossed-in-Register (EIR)
THICKNESS	6.5 mm	FINISH	UV Coating and Tempering
LENGTH	59.5 inches	WEIGHT PER BOX	53 lbs
WEAR LAYER	0.5 mm (20 mil)	COVERAGE PER BOX	21.45 sq ft
CONSTRUCTION	SPC Vinyl with IXPE Underlayment	EDGE DETAIL	Painted Micro-Bevel

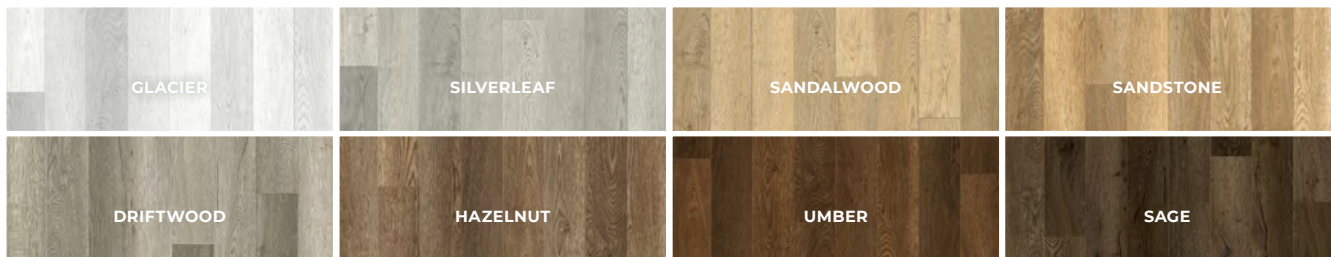

INSTALLATION

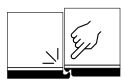

EASY CLICK

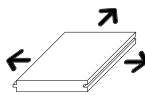

FLOATING

MOULDINGS AVAILABLE



TREAD



NOSING



T-MOULDING



REDUCER



QUARTER ROUND



END CAP



RESILIENT

Versatile. Sensible. Effortless.

The Resilient line of Garrison floors represents a wide range of easy-to-install, high quality vinyl and laminate options. Get the look and feel of real hardwood flooring with the proven durability of Garrison water-resistant technology.



SCAN WITH PHONE CAMERA FOR IMAGES AND MORE INFORMATION

www.garrisoncollection.com

(800) 300-5158 | info@garrisoncollection.com

Sample Variation Disclaimer: Due to the natural variations in color, grain, and texture inherent in the hardwood products used to design this flooring, flooring will vary from plank to plank and may vary slightly from these samples. Please expect variation in all flooring. Samples that have been exposed to sunlight or naturally aged may differ slightly from the product received. Garrison accepts no liability for claims due to variations in color, grain, and/or character between these samples and your installed floor. INSTALLATION IS ACCEPTANCE.

Product Disclaimer: All measurements are nominal. Wear layer refers to top layer thickness prior to treatment. Embossing may marginally affect wear layer thickness. All boxes include starter boards.

Order Disclaimer: We recommend buying all flooring at the same time for your project. When ordering, always factor in at least one full box for any/all unforeseen damage that may occur during the life of your floor. Please consider and allow for a waste factor of 3-5% on normal layouts and 5-10% on detailed layouts such as 45-degree angles, patterns, border work, etc. Please also include end joint stagger and note that minor imperfections are to be cut off prior to installation.

Installation Disclaimer: This flooring must be installed in accordance to our installation instructions, included in all cartons of our flooring. Proper subfloor testing must be performed and Garrison Vinyl Moisture Barrier and 3M Seam Tape (or equivalent products) must be used at installation. More detailed installation instructions can be found on our website at garrisoncollection.com. Improper installation will void your warranty.

Warranty Disclaimer: This flooring comes fully finished from the factory and requires no immediate surface treatment following installation. Improper installation or the use of improper products and/or cleaning methods will void your warranty. Please refer to full Care & Maintenance Guide available for this flooring at garrisoncollection.com.



GARRISON



HIGH SIERRA

SUMMIT SKY SPC

Stand above all other vinyl flooring options with Summit Sky, our cleanest and most modern European Oak looking vinyl, available in both classic plank and stylish herringbone construction. This water-resistant flooring will do wonders in any space that calls for the durability of vinyl, with the clean looks of select grade hardwood flooring. Summit Sky is constructed with an easy click installation system, making it as convenient as it is elegant. With 6.5mm thick planks, precisely micro-beveled edges, and four incredible colors, say no to repetitive and dull vinyl and reach the top with Summit Sky SPC.

WIDTH	Herringbone: 5 inches Plank: 7 inches	SURFACE TEXTURE	Deep Embossed
THICKNESS	6.5 mm	FINISH	UV Coating and Tempering
LENGTH	Herringbone: 24 inches Plank: 60 inches	WEIGHT PER BOX	Herringbone: 41.89 lbs Plank: 43.21 lbs
WEAR LAYER	0.5 mm (20 mil)	COVERAGE PER BOX	Herringbone: 20.34 sq ft Plank: 20.67 sq ft
CONSTRUCTION	SPC Vinyl with IXPE Underlayment	EDGE DETAIL	Painted Micro-Bevel

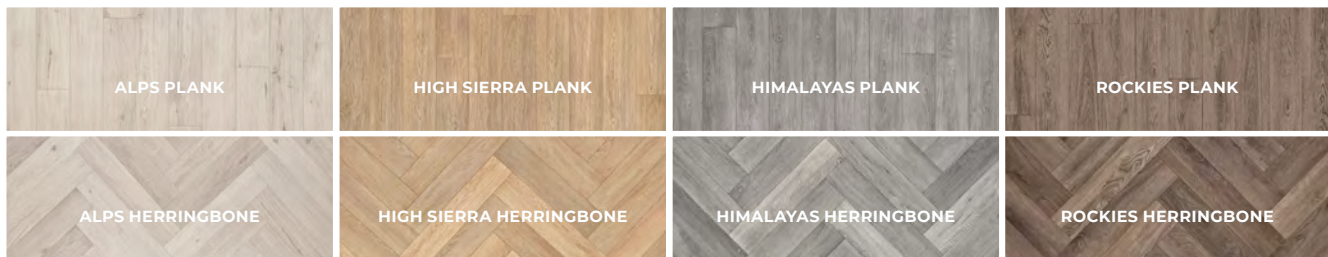

INSTALLATION

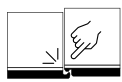

EASY CLICK

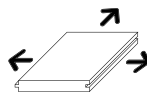

FLOATING

MOULDINGS AVAILABLE



TREAD



NOSING



REDUCER



QUARTER ROUND

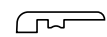

END CAP



T-MOULDING



RESILIENT

Versatile. Sensible. Effortless.

The Resilient line of Garrison floors represents a wide range of easy-to-install, high quality vinyl and laminate options. Get the look and feel of real hardwood flooring with the proven durability of Garrison water-resistant technology.



SCAN WITH PHONE CAMERA FOR IMAGES AND MORE INFORMATION

www.garrisoncollection.com

(800) 300-5158 | info@garrisoncollection.com

Sample Variation Disclaimer: Due to the natural variations in color, grain, and texture inherent in the hardwood products used to design this flooring, flooring will vary from plank to plank and may vary slightly from these samples. Please expect variation in all flooring. Samples that have been exposed to sunlight or naturally aged may differ slightly from the product received. Garrison accepts no liability for claims due to variations in color, grain, and/or character between these samples and your installed floor. INSTALLATION IS ACCEPTANCE.

Product Disclaimer: All measurements are nominal. Wear layer refers to top layer thickness prior to treatment. Embossing may marginally affect wear layer thickness. All boxes include starter boards.

Order Disclaimer: We recommend buying all flooring at the same time for your project. When ordering, always factor in at least one full box for any/all unforeseen damage that may occur during the life of your floor. Please consider and allow for a waste factor of 3-5% on normal layouts and 5-10% on detailed layouts such as 45-degree angles, patterns, border work, etc. Please also include end joint stagger and note that minor imperfections are to be cut off prior to installation.

Installation Disclaimer: This flooring must be installed in accordance to our installation instructions, included in all cartons of our flooring. Proper subfloor testing must be performed and Garrison Vinyl Moisture Barrier and 3M Seam Tape (or equivalent products) must be used at installation. More detailed installation instructions can be found on our website at garrisoncollection.com. Improper installation will void your warranty.

Warranty Disclaimer: This flooring comes fully finished from the factory and requires no immediate surface treatment following installation. Improper installation or the use of improper products and/or cleaning methods will void your warranty. Please refer to full Care & Maintenance Guide available for this flooring at garrisoncollection.com.



GARRISON

SAN MARINO OAK

AQUA BLUE WPC

Finally, a flooring solution that is easy to install, simple to maintain, extremely durable, and looks incredible. This WPC collection features stunning colors and grain patterns that will appeal to the most discerning of critics. All Garrison WPC flooring is constructed with a uniquely composed rigid-core material that makes for a resilient, comfortable, and incredibly durable flooring option. With a thick 8mm construction, EVA foam underlayment, six foot lengths, precisely micro-beveled edges, and an embossed surface texture, all flooring in our Aquablue collection looks and feels amazing.

WIDTH	7 inches	SURFACE TEXTURE	Deep Embossed
THICKNESS	8 mm	FINISH	UV Coating and Tempering
LENGTH	6 feet	WEIGHT PER BOX	46 lbs
WEAR LAYER	0.5 mm (20 mil)	COVERAGE PER BOX	28.05 sqft
CONSTRUCTION	WPC Vinyl with EVA Underlayment	EDGE DETAIL	Painted Micro-Bevel

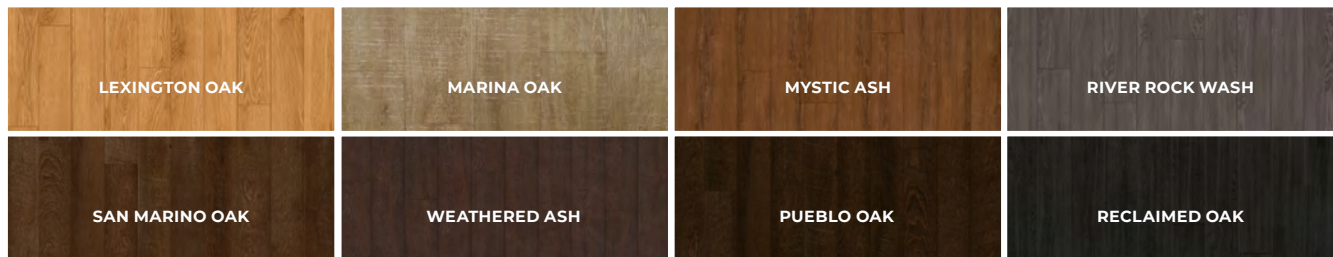

INSTALLATION

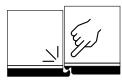

EASY CLICK

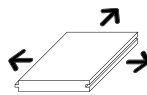

FLOATING

MOULDINGS AVAILABLE



TREAD



NOSING



T-MOULDING



REDUCER



QUARTER ROUND



END CAP



RESILIENT

Versatile. Sensible. Effortless.

The Resilient line of Garrison floors represents a wide range of easy-to-install, high quality vinyl and laminate options. Get the look and feel of real hardwood flooring with the proven durability of Garrison water-resistant technology.



SCAN WITH PHONE CAMERA FOR IMAGES AND MORE INFORMATION

www.garrisoncollection.com

(800) 300-5158 | info@garrisoncollection.com

Sample Variation Disclaimer: Due to the natural variations in color, grain, and texture inherent in the hardwood products used to design this flooring, flooring will vary from plank to plank and may vary slightly from these samples. Please expect variation in all flooring. Samples that have been exposed to sunlight or naturally aged may differ slightly from the product received. Garrison accepts no liability for claims due to variations in color, grain, and/or character between these samples and your installed floor. **INSTALLATION IS ACCEPTANCE.**

Product Disclaimer: All measurements are nominal. Wear layer refers to top layer thickness prior to treatment. Embossing may marginally affect wear layer thickness. All boxes include starter boards.

Order Disclaimer: We recommend buying all flooring at the same time for your project. When ordering, always factor in at least one full box for any/all unforeseen damage that may occur during the life of your floor. Please consider and allow for a waste factor of 3-5% on normal layouts and 5-10% on detailed layouts such as 45-degree angles, patterns, border work, etc. Please also include end joint stagger and note that minor imperfections are to be cut off prior to installation.

Installation Disclaimer: This flooring must be installed in accordance to our installation instructions, included in all cartons of our flooring. Proper subfloor testing must be performed and Garrison Vinyl Moisture Barrier and 3M Seam Tape (or equivalent products) must be used at installation. More detailed installation instructions can be found on our website at garrisoncollection.com. Improper installation will void your warranty.

Warranty Disclaimer: This flooring comes fully finished from the factory and requires no immediate surface treatment following installation. Improper installation or the use of improper products and/or cleaning methods will void your warranty. Please refer to full Care & Maintenance Guide available for this flooring at garrisoncollection.com.



HAVASU OAK

AQUA BLUE II WPC

This incredible collection takes the success of our Aquablue flooring to another level, with a thicker construction and wider planks. All Garrison WPC flooring is constructed with a uniquely composed rigid-core material that makes for a resilient, comfortable, and incredibly durable flooring option. Featuring a 12mm construction, EVA foam underlayment, six foot lengths, precisely micro-beveled edges, and an embossed surface texture, this collection is the perfect choice for high-use locations requiring flooring that looks amazing and performs well doing so.

WIDTH	9 inches	SURFACE TEXTURE	Varies (see below)
THICKNESS	12 mm	FINISH	UV Coating and Tempering
LENGTH	6 feet	WEIGHT PER BOX	64 lbs
WEAR LAYER	0.5 mm (20 mil)	COVERAGE PER BOX	26.95 sq ft
CONSTRUCTION	WPC Vinyl with EVA Underlayment	EDGE DETAIL	Painted Micro-Bevel



INSTALLATION

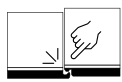

EASY CLICK

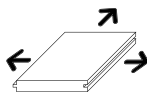

FLOATING

MOULDINGS AVAILABLE



TREAD



NOSING



T-MOULDING



REDUCER



QUARTER ROUND



END CAP



RESILIENT

Versatile. Sensible. Effortless.

The Resilient line of Garrison floors represents a wide range of easy-to-install, high quality vinyl and laminate options. Get the look and feel of real hardwood flooring with the proven durability of Garrison water-resistant technology.



SCAN WITH PHONE CAMERA FOR IMAGES AND MORE INFORMATION

www.garrisoncollection.com

(800) 300-5158 | info@garrisoncollection.com

Sample Variation Disclaimer: Due to the natural variations in color, grain, and texture inherent in the hardwood products used to design this flooring, flooring will vary from plank to plank and may vary slightly from these samples. Please expect variation in all flooring. Samples that have been exposed to sunlight or naturally aged may differ slightly from the product received. Garrison accepts no liability for claims due to variations in color, grain, and/or character between these samples and your installed floor. INSTALLATION IS ACCEPTANCE.

Product Disclaimer: All measurements are nominal. Wear layer refers to top layer thickness prior to treatment. Embossing may marginally affect wear layer thickness. All boxes include starter boards.

Order Disclaimer: We recommend buying all flooring at the same time for your project. When ordering, always factor in at least one full box for any/all unforeseen damage that may occur during the life of your floor. Please consider and allow for a waste factor of 3-5% on normal layouts and 5-10% on detailed layouts such as 45-degree angles, patterns, border work, etc. Please also include end joint stagger and note that minor imperfections are to be cut off prior to installation.

Installation Disclaimer: This flooring must be installed in accordance to our installation instructions, included in all cartons of our flooring. Proper subfloor testing must be performed and Garrison Vinyl Moisture Barrier and 3M Seam Tape (or equivalent products) must be used at installation. More detailed installation instructions can be found on our website at garrisoncollection.com. Improper installation will void your warranty.

Warranty Disclaimer: This flooring comes fully finished from the factory and requires no immediate surface treatment following installation. Improper installation or the use of improper products and/or cleaning methods will void your warranty. Please refer to full Care & Maintenance Guide available for this flooring at garrisoncollection.com.



GARRISON

LEO

ZODIAC W-SPC

Can't decide between hardwood and vinyl? Get the best of both worlds with this collection of hybrid hardwood flooring. Constructed with a real wood wear layer and an SPC core with an EVA foam underlayment, this technologically advanced collection allows for the ease of vinyl flooring installation with the real look and feel of hardwood flooring. Available in European Oak, Hickory, and Maple species, and in 10 multi-dimensional colors, this collection is truly out of this world. If you are looking for the latest in flooring technology, it is in the stars that Zodiac is the right choice for you.

WIDTH	7.5 inches	CONSTRUCTION	Hardwood Wear Layer + SPC Vinyl with IXPE Underlayment
THICKNESS	8 mm	SURFACE TEXTURE	Taurus: Smooth All Other Colors: Light Wire-Brush
LENGTH	Random, Up to 6 feet 3 inches	FINISH	Aluminum Oxide
WEAR LAYER	1.2 mm	EDGE DETAIL	Micro-Bevel
SPECIES	Varies (see below)	WEIGHT PER BOX	65lbs
GRADE	Select Character	COVERAGE PER BOX	23.32 sq ft

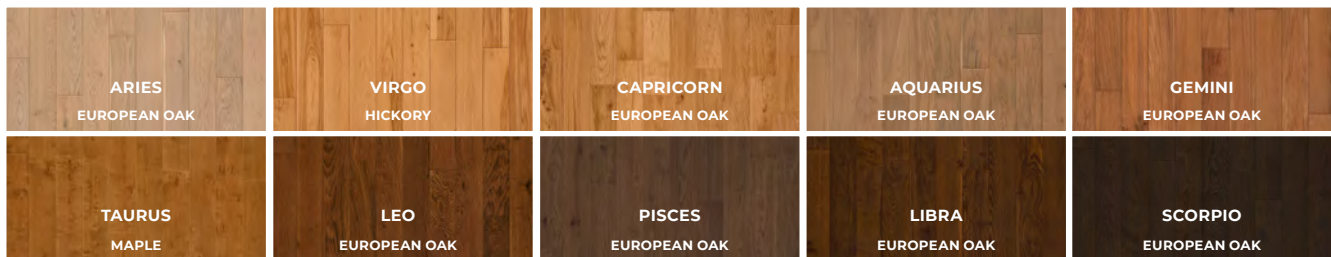

INSTALLATION

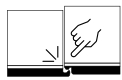

EASY CLICK

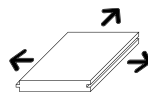

FLOATING

MOULDINGS AVAILABLE



T-MOULDING



NOSING



REDUCER



END CAP



RESILIENT

Versatile. Sensible. Effortless.

The Resilient line of Garrison floors represents a wide range of easy-to-install, high quality vinyl and laminate options. Get the look and feel of real hardwood flooring with the proven durability of Garrison water-resistant technology.

RESIDENTIAL	
LIMITED 25 YEAR STRUCTURE	LIMITED 10 YEAR FINISH
COMMERCIAL	
LIMITED 10 YEAR STRUCTURE	LIMITED 3 YEAR FINISH



SCAN WITH PHONE CAMERA FOR IMAGES AND MORE INFORMATION

www.garrisoncollection.com

(800) 300-5158 | info@garrisoncollection.com

Sample Variation Disclaimer: Due to the natural variations in color, grain, and texture inherent in the hardwood products used to design this flooring, flooring will vary from plank to plank and may vary slightly from these samples. Please expect variation in all flooring. Samples that have been exposed to sunlight or naturally aged may differ slightly from the product received. Garrison accepts no liability for claims due to variations in color, grain, and/or character between these samples and your installed floor. INSTALLATION IS ACCEPTANCE.

Product Disclaimer: All measurements are nominal. Wear layer refers to top layer thickness prior to treatment. Embossing may marginally affect wear layer thickness. All boxes include starter boards.

Order Disclaimer: We recommend buying all flooring at the same time for your project. When ordering, always factor in at least one full box for any/all unforeseen damage that may occur during the life of your floor. Please consider and allow for a waste factor of 3-5% on normal layouts and 5-10% on detailed layouts such as 45-degree angles, patterns, border work, etc. Please also include end joint stagger and note that minor imperfections are to be cut off prior to installation.

Installation Disclaimer: This flooring must be installed in accordance to our installation instructions, included in all cartons of our flooring. Proper subfloor testing must be performed and Garrison Vinyl Moisture Barrier and 3M Seam Tape (or equivalent products) must be used at installation. More detailed installation instructions can be found on our website at garrisoncollection.com. Improper installation will void your warranty.

Warranty Disclaimer: This flooring comes fully finished from the factory and requires no immediate surface treatment following installation. Improper installation or the use of improper products and/or cleaning methods will void your warranty. Please refer to full Care & Maintenance Guide available for this flooring at garrisoncollection.com.



GARRISON



BOARDWALK

AZUL WATERS

This collection combines the durability of laminate flooring construction with the beauty of realistic hardwood colors and patterns. With our water-resistant technology, matte aluminum oxide finish, and variety of textures, get the aesthetic and feel of wood at a cost-effective price point. Backed by our industry leading warranty and ease of maintenance, all flooring in our Azul Waters collection is as breathtaking and memorable as a pristine ocean view.

WIDTH	6-1/2 inches	SURFACE TEXTURE	Varies (see below)
THICKNESS	12 mm	WEIGHT PER BOX	50 lbs
LENGTH	4 feet	COVERAGE PER BOX	21.58 sqft
FINISH	Aluminum Oxide	EDGE DETAIL	V-Groove Edge
CONSTRUCTION	Laminate		

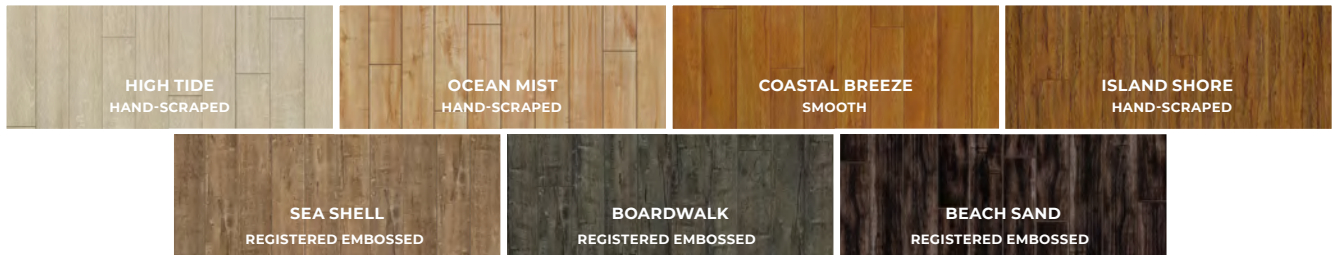

INSTALLATION

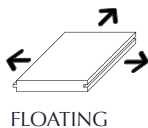

MOULDINGS AVAILABLE



RESILIENT

Versatile. Sensible. Effortless.

The Resilient line of Garrison floors represents a wide range of easy-to-install, high quality vinyl and laminate options. Get the look and feel of real hardwood flooring with the proven durability of Garrison water-resistant technology.



SCAN WITH PHONE CAMERA FOR IMAGES AND MORE INFORMATION

www.garrisoncollection.com

(800) 300-5158 | info@garrisoncollection.com

Sample Variation Disclaimer: Due to the natural variations in color, grain, and texture inherent in the hardwood products used to design this flooring, flooring will vary from plank to plank and may vary slightly from these samples. Please expect variation in all flooring. Samples that have been exposed to sunlight or naturally aged may differ slightly from the product received. Garrison accepts no liability for claims due to variations in color, grain, and/or character between these samples and your installed floor. **INSTALLATION IS ACCEPTANCE.**

Product Disclaimer: All measurements are nominal. Wear layer refers to top layer thickness prior to treatment. Embossing may marginally affect wear layer thickness. All boxes include starter boards.

Order Disclaimer: We recommend buying all flooring at the same time for your project. When ordering, always factor in at least one full box for any/all unforeseen damage that may occur during the life of your floor. Please consider and allow for a waste factor of 3-5% on normal layouts and 5-10% on detailed layouts such as 45-degree angles, patterns, border work, etc. Please also include end joint stagger and note that minor imperfections are to be cut off prior to installation.

Installation Disclaimer: This flooring must be installed in accordance to our installation instructions, included in all cartons of our flooring. Proper subfloor testing must be performed and Garrison Vinyl Moisture Barrier and 3M Seam Tape (or equivalent products) must be used at installation. More detailed installation instructions can be found on our website at garrisoncollection.com. Improper installation will void your warranty.

Warranty Disclaimer: This flooring comes fully finished from the factory and requires no immediate surface treatment following installation. Improper installation or the use of improper products and/or cleaning methods will void your warranty. Please refer to full Care & Maintenance Guide available for this flooring at garrisoncollection.com.



COUNTRY CHARM LVT

Achieve a warm, inviting look with these stunning colors available in a glue-down LVT construction. Inspired by the charm of hardwood flooring traditionally created in the South, this collection combines natural tones and textures with the durability and ease of LVT flooring. Hard-wearing, water-resistant, and providing an excellent grip, LVT flooring has never been easier or more beautiful than Country Charm.

WIDTH	7 inches	FINISH	UV Coating
THICKNESS	3 mm	WEIGHT PER BOX	40 lbs
LENGTH	4 feet	COVERAGE PER BOX	35 sq ft
WEAR LAYER	0.5 mm (20 mil)	EDGE DETAIL	Painted Micro-Bevel Edge
CONSTRUCTION	Glue Down LVT		

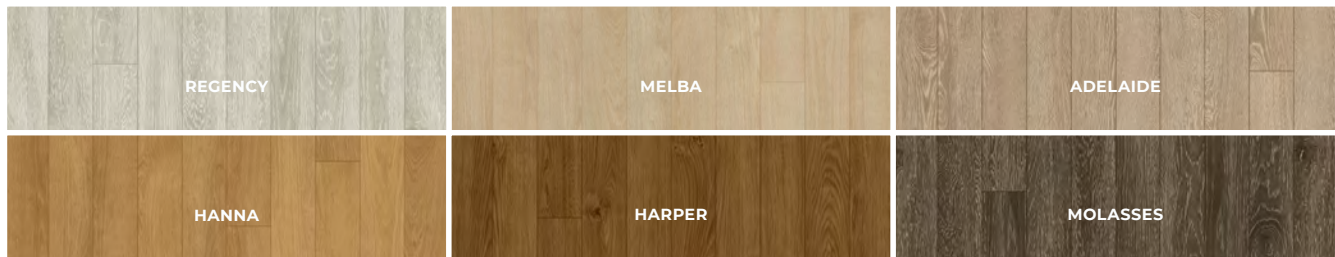

INSTALLATION

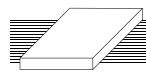

GLUE-DOWN



RESILIENT

Versatile. Sensible. Effortless.

The Resilient line of Garrison floors represents a wide range of easy-to-install, high quality vinyl and laminate options. Get the look and feel of real hardwood flooring with the proven durability of Garrison water-resistant technology.



SCAN WITH PHONE CAMERA FOR IMAGES AND MORE INFORMATION

www.garrisoncollection.com

(800) 300-5158 | info@garrisoncollection.com

Sample Variation Disclaimer: Due to the natural variations in color, grain, and texture inherent in the hardwood products used to design this flooring, flooring will vary from plank to plank and may vary slightly from these samples. Please expect variation in all flooring. Samples that have been exposed to sunlight or naturally aged may differ slightly from the product received. Garrison accepts no liability for claims due to variations in color, grain, and/or character between these samples and your installed floor. **INSTALLATION IS ACCEPTANCE.**

Product Disclaimer: All measurements are nominal. Wear layer refers to top layer thickness prior to treatment. Embossing may marginally affect wear layer thickness. All boxes include starter boards.

Order Disclaimer: We recommend buying all flooring at the same time for your project. When ordering, always factor in at least one full box for any/all unforeseen damage that may occur during the life of your floor. Please consider and allow for a waste factor of 3-5% on normal layouts and 5-10% on detailed layouts such as 45-degree angles, patterns, border work, etc. Please also include end joint stagger and note that minor imperfections are to be cut off prior to installation.

Installation Disclaimer: This flooring must be installed in accordance to our installation instructions, included in all cartons of our flooring. Proper subfloor testing must be performed and Garrison Vinyl Moisture Barrier and 3M Seam Tape (or equivalent products) must be used at installation. More detailed installation instructions can be found on our website at garrisoncollection.com. Improper installation will void your warranty.

Warranty Disclaimer: This flooring comes fully finished from the factory and requires no immediate surface treatment following installation. Improper installation or the use of improper products and/or cleaning methods will void your warranty. Please refer to full Care & Maintenance Guide available for this flooring at garrisoncollection.com.